

# Soffit Slab



fire stopping  
within the soffit

## key features

- » Provides fire stopping within the soffit at the party wall junction
- » Excellent thermal and acoustic properties
- » One size fits most roof pitches and soffit dimensions
- » Manufactured from foil faced mineral wool

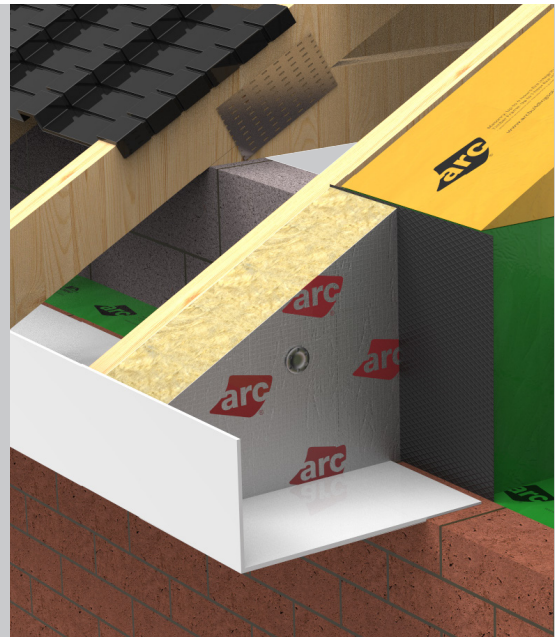

## Application

The ARC Soffit Slab is designed to fill the void within the soffit, providing a fire, thermal and acoustic barrier between dwellings. The barrier is manufactured from rockfibre mineral wool, with a foil facing to ensure an effective smoke barrier is created. An exact fit can be created to form an effective barrier at this junction.

## Installation

ARC Soffit Slab is designed to be cut to size to fill the void within the soffit at the party wall location. The product must fully fill the soffit with no gaps remaining, and be fixed using supplied fixing to provide extra support in the event of a fire.

- » Measure the size of the soffit at the party wall junction, taking the roof pitch and brick height into account. We recommend adding 5mm to your measured dimensions to ensure that the product will hold in place with a tight fit.
- » Take the square Soffit Slab and cut it to size using the measurements with the additional 5mm, ensuring the slab will completely fill the soffit.
- » Push fit the slab into place allowing for a minimum 75mm overlap with the party wall leaf. There should be no gaps remaining around the Soffit Slab once it is closed in.
- » Secure through to the timber batten using the helical fixing supplied.

## Fire Properties

ARC Soffit Slab complies with building regulations for fire stopping at the pitched roof party wall detail, as well as NHBC 7.2.16.

## Standards

ARC Soffit Slab is manufactured using rockfibre mineral wool which achieves a fire classification of Euroclass A1 as defined in BS EN 13501-1, and conforms to BS EN 13162 and EN16001 Energy Management Systems.

ARC's rockfibre mineral wool insulation has a thermal conductivity of 0.037W/mK.

Don't take our word for it, see our certification...



### Storage and Packaging

ARC Soffit Slabs are supplied in polythene packs which are designed for transporting and protecting the products. It is not recommended that the packs are stored in direct sunlight. When storing the barriers for longer periods of time it is recommended that the product should be stored indoors, or under cover.

### Environment

No CFCs or HCFCs are involved in the manufacturing process of ARC's rockfibre mineral wool insulation. The material presents no known threat to the environment and is classed as ODP and GWP zero.

ARC Soffit Slab has a Green Guide rating of A+.

### Health and Safety

ARC Building Solutions has an approved Health and Safety Policy and is committed to working and supplying products safely. ARC's rockfibre mineral wool is not classed as a possible human carcinogen. We have assessed products as required by Substances Hazardous to Health Regulations (COSHH). An ARC COSHH data sheet is available and can be downloaded from ARC's website.

### Standard Dimensions & Packaging Specification

Product Code	Dimensions	Pack Qty	Packs per Pallet	Suitable fixing
SSL100/600/450	450 x 600 x 100mm	8	10	SSLFIXING145
SSL150/600/500	500 x 600 x 150mm	6	8	SSLFIXING200

Product Code	Dimensions	Suitable fixing
SSLFIXING145	145mm	100mm
SSLFIXING200	200mm	150mm